

COFA

CHANGE THE BLADE AND SPRING COFA C3-5M X

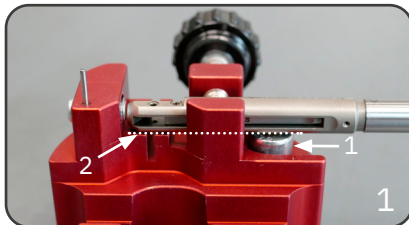

Place the tool in the mounting fixture. Adjust the positioning stop **(1)** for the height of the blade housing so that it is level with the surface **(2)**.

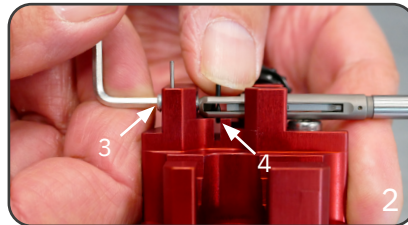

Adjust the positioning stop on the left **(3)** so that the roll pin of the blade is located above the groove **(4)**.

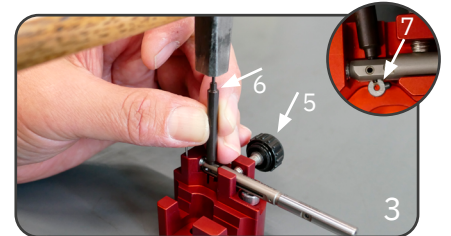

Tighten the preload **(5)**. Remove the assembly pin by inserting the assembly tool and drive it slowly out of the tool body with a small hammer **(6)**. Remove the blade by pushing it out of the tool body with the assembly tool **(7)**.

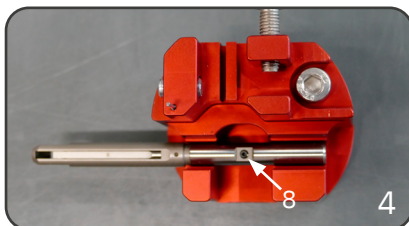

Place the tool body onto the front rest with the split pin orientated upwards **(8)**.

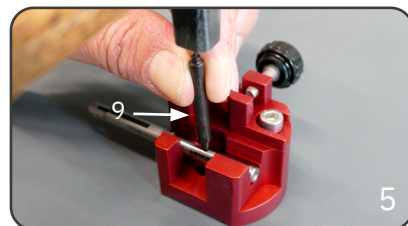

Remove the split pin by inserting the assembly tool and drive it slowly out of the tool body with a small hammer **(9)**.

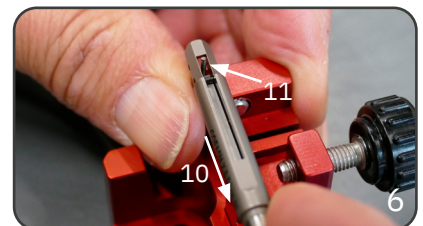

Push the spring back – at the front edge of the spring – over the pre-loaded split pin **(10)** by using the pin of the mounting fixture **(11)**.

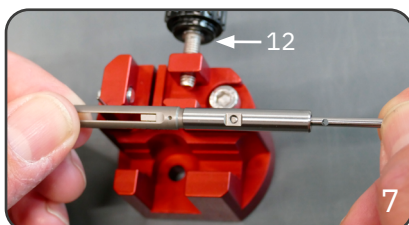

Now, the preload is released **(12)** and the spring can be pushed back easily out of the tool body by hand or with the help of the assembly tool pin or the pin of the mounting fixture.

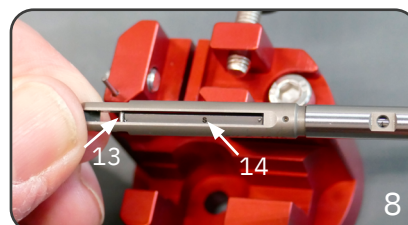

Insert the new spring until it stops at the split pin **(13)**.

Note: The marking of the spring must be visible **(14)**.

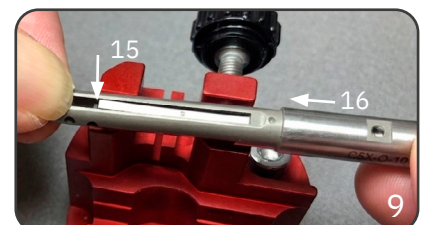

Now lift and slide the spring over the split pin by pressing the tip of the spring on the pin of the mounting fixture **(15)** while at the same time pushing the spring from its back end further into the tool body **(16)**.

Video:



If backward cutting → spring above split pin.

If forward cutting → spring below split pin.

COFA

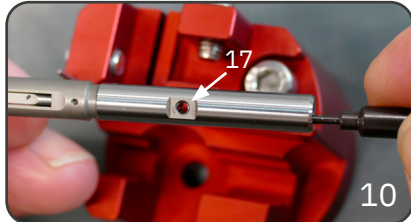

Check the position of the spring. The hole for the split pin must be at the same position as the hole in the tool body **(17)**.

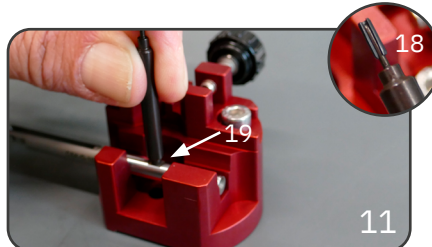

Place the tool body on the front rest of the mounting fixture and insert the split pin **(18)** with the assembly tool and a small hammer **(19)**.

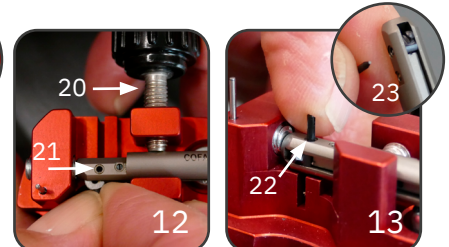

Tighten the preload **(20)**. Insert the new blade into the tool so that the spring is in the notch on the blade. The hole for the blade must be at the same position as the hole in the tool body **(21)**. Mount the assembly pin by inserting the assembly tool and drive it slowly into the tool body with a small hammer **(22)**. Then brake off the protruding pin **(23)**.

Video:

